

0F3MR320L090000 FKT-M090

SLIPPER CLUTCH FOR KTM 350

ASSEMBLY INSTRUCTIONS

The hub / drum unit is supplied pre-assembled. IN CASE OF NEED, to perform an inspection of the state of the ramps, follow the HUB / DRUM GROUP DISASSEMBLY PROCEDURE indicated below.

Insert the hub / drum unit on the primary shaft. If necessary, to further facilitate the operation, it is possible to fix the drum (0F3SR450D15002B) on the hub (0F3SR450D15001B), in the rest position, with an M6x1 screw.

ATTENTION: the original clutch spacer must be kept between the original bell and the hub (0F3SR450D15001B), otherwise malfunctions and / or damage to parts may occur.

Reinstall the original clutch discs maintaining their original sequence. The total height of the disc pack must be 38.2 ± 0.3 mm.

ATTENTION: if with the original disc pack there are two rings (one of which is conical), positioned inside a lined disc, set them aside and DO NOT use them when reassembling the disc pack on the STM clutch.

Remove the M6X1 screw, if previously mounted.

Check that the drum stop stop screw (0F3SR300J070086) does not protrude from the surface of the drum stop (0F3SR230P140009) on which the spring stop hub (0F3SR450D150007) will rest. Check that the secondary spring support shim (0F3SR540B140016) is properly inserted in the drum seat

(0F3SR450D15002B). Insert the secondary spring (0S2085) in its seat inside the drum (0F3SR450D15002B) with a small amount of grease. Check that the primary spring support (003SUZ119) is well inserted in the pressure plate seat (0F3SR230C220003). Insert the pressure plate

(0F3SR230C220003) in their seats on the drum (0F3SR450D15002B). Insert the Evoluzione Racing spring (0S1125) in the seat of the pressure plate (0F3SR230C220003).

Pre-assemble the spring stop assembly: hold the spring pressure plate (0F3CR620E07A008) with the bearing guide (grooved part) upwards as shown, insert the thrust bearing (003MG007) inside it and finally the spring stop hub (0F3SR450D150007). Insert the complete spring stop unit inside the pressure plate (0F3SR230C220003), making sure that the 9 tabs of the spring pressure disc (0F3CR620E07A008) overlap the 9 spokes of the spring (0S1125).

Insert the toothed washer (0F3SR450B170017) with the convex part upwards and then the nut (0F3SR450D150013) inside the spring stop hub

(0F3SR450D150007). Screw the nut (0F3SR450D150013) onto the primary shaft using the wrench (0A5SR450A220000), included in the package and tightening with the torque wrench to the torque recommended by the vehicle manufacturer. It is also suggested to use the specific key (002AMS001), not present in the packaging, to lock the pressure plate (0F3SR230C220003). Pre-assemble the complete bearing support: insert the bearing and the rod centering device (recovered from the original clutch) in the bearing support seat

(0F3SR450D150004). Place the complete bearing support in the appropriate seat of the pressure plate (0F3SR230C220003) making sure to insert it correctly in the respective grooves and secure it with the six screws (901VT018) and the six anti-loosening washers (901RD007).

When assembly is complete, repeatedly activate the clutch lever, checking that it functions correctly. Adjust the lever play if necessary.

HUB / DRUM UNIT DISASSEMBLY PROCEDURE

ATTENTION: perform this operation only after having removed the clutch from the gear shaft. Remove the drum stop locking screw

(0F3SR300J070086), rotate the drum stop by 60 ° clockwise

(0F3SR230P140009) and then extract it. At this point it is possible to separate the hub (0F3SR450D15001B), drum (0F3SR450D15002B) and balls (001MG025).

TO REASSEMBLE THE GROUP: place the 6 balls (001MG025) at the bottom of the hub grooves (0F3SR450D15001B) applying a small amount of grease, then place the drum (0F3SR450D15002B) on the hub

(0F3SR450D15001B) in rest position. Position the drum stop (0F3SR230P140009) on the hub (0F3SR450D15001B), aligning its three fins with the relevant seats on the hub (0F3SR450D15001B), then rotate it until the holes between the two pieces are aligned, and finally reinsert the screw completely

(0F3SR300J070086). **Check that the drum stop (0F3SR230P140009) is correctly locked on the hub (0F3SR450D15001B) and that the screw (0F3SR300J070086) does not protrude from the surface on which the spring stop hub (0F3SR450D150007) will rest.**

GENERAL SAFETY REGULATIONS

- IN THIS SHEET ARE REPORTED THE DIRECTIONS TO PERFORM CORRECTLY THE CLUTCH ASSEMBLY OPERATIONS.
- STM RESERVES THE RIGHT, WITHOUT NOTICE, TO INTRODUCE ANY TECHNICAL CHANGE WHENEVER DEEMED IT TO BE NECESSARY TO IMPROVE FUNCTION AND QUALITY OF THE PRODUCTS.
- ASSEMBLY OPERATIONS MUST BE PERFORMED BY A SKILLED TECHNICIAN AND MUST BE SCRUPULOUSLY OBSERVED.
- BEFORE MOUNTING THE CLUTCH MAKE A COMPLETE INSPECTION OF THE MOTORBIKE COMPONENTS, IN ORDER TO VERIFY THE POSSIBLE PRESENCE OF FAULTS OR ANOMALIES ON THE VEHICLE.
- MAKE SURE THAT THERE ARE NO MISSING/DAMAGED PARTS IN THE CLUTCH KIT.
- SOME PARTS OF THE CLUTCH AND ITS COMPONENTS CAN HAVE SHARP SURFACE: HANDLE WITH CARE.
- SOME COMPONENTS OF THE CLUTCH, BECAUSE OF THEIR SMALL DIMENSIONS CAN BE SWALLOWED: KEEP AWAY FROM CHILDREN.

STM ITALY

Via A. Olivetti 15 - 10020 - Riva presso Chieri (TO)
www.stmitaly.com - contact@stmitaly.com

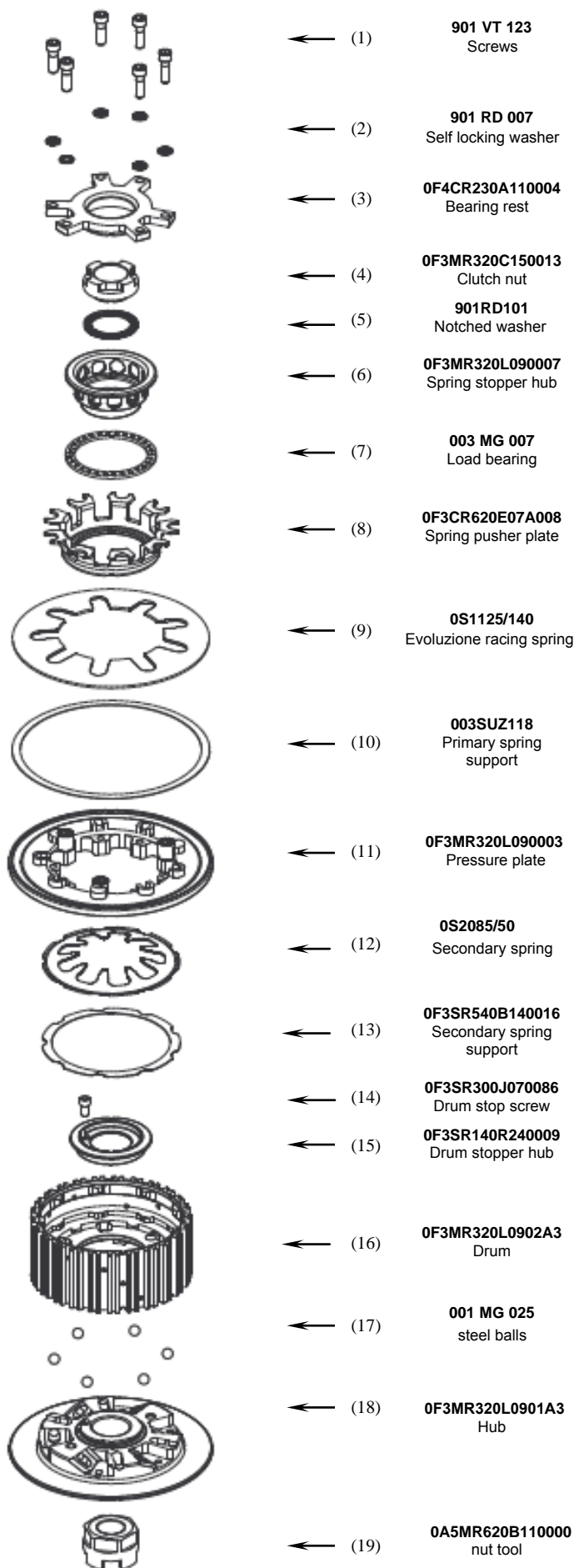

901 VT 123
Screws

901 RD 007
Self locking washer

0F4CR230A110004
Bearing rest

0F3MR320C150013
Clutch nut

901RD101
Notched washer

0F3MR320L090007
Spring stopper hub

003 MG 007
Load bearing

0F3CR620E07A008
Spring pusher plate

0S1125/140
Evoluzione racing spring

003SUZ118
Primary spring support

0F3MR320L090003
Pressure plate

0S2085/50
Secondary spring

0F3SR540B140016
Secondary spring support

0F3SR300J070086
Drum stop screw

0F3SR140R240009
Drum stopper hub

0F3MR320L0902A3
Drum

001 MG 025
steel balls

0F3MR320L0901A3
Hub

0A5MR620B110000
nut tool