

0F3SR450B170000
FMV S030

SLIPPER CLUTCH KIT FOR
MV AGUSTA F4 750 "gold series" and
MV AGUSTA BRUTALE 750
with M25X1,5 clutch shaft threading

ASSEMBLY INSTRUCTIONS

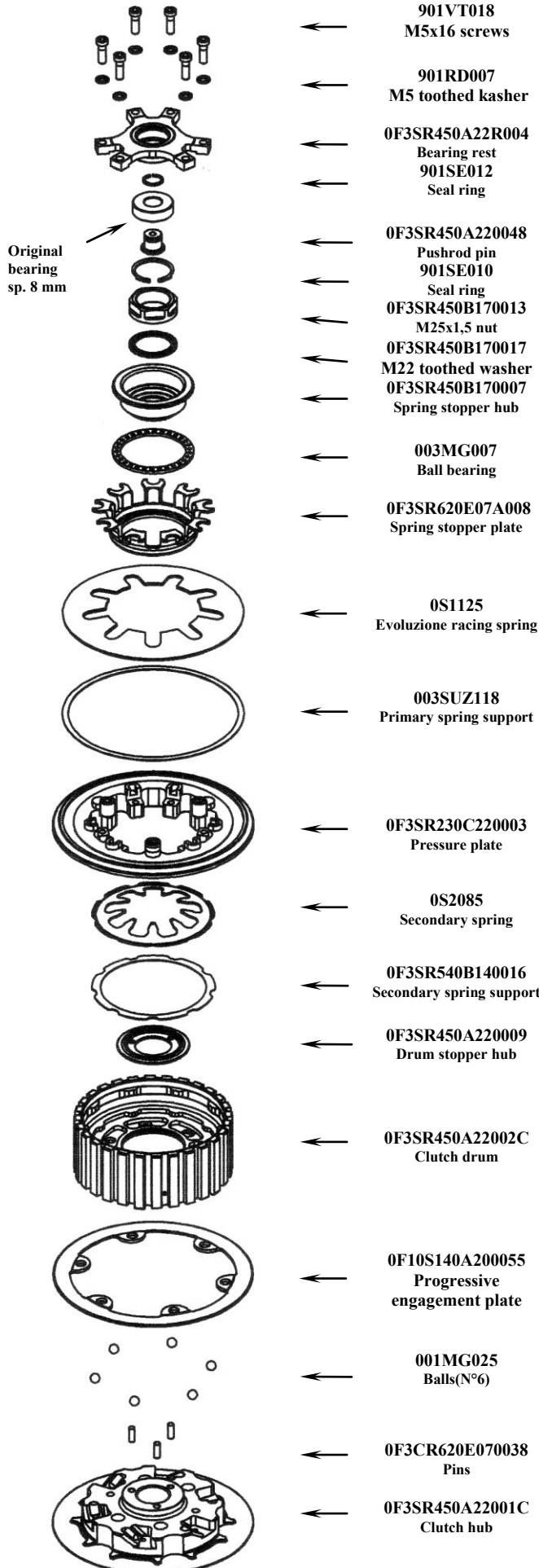

- Pre-assemble the hub pack: put progressive engagement plate (003MG015) on hub (0F3SR450A22001C), with the step facing up, put it correctly into its seats, then check that pushing on one side the other side lifts up. Place at the bottom of the grooves the 6 steel balls (001MG025) onto the hub (0F3SR450A22001C) using a small amount of grease. With an M6 screw fix the clutch drum (0F3SR450A22002C) onto the clutch hub (0F3SR450A22001C) in an at-rest position.
- Insert the hub pack onto the main shaft.
- **Mount the complete plates pack of the MV Agusta F4 1000 removing the two rings.** The total thickness of the pack should be 42.5 mm.
- Remove the screw used to hold hub (0F3SR450A22001C) and drum (0F3SR450A22002C) together.
- Insert the drum stopper hub (0F3SR450A220009) into the hub housing (0F3SR450A22001C) taking care that the three pins (0F3CR620E070038) inside the hub (0F3SR450A22001C) place themselves in the three holes present on the drum stopper hub (0F3SR450A220009) and that they are on a level with the superior surface of the drum stopper hub.
- Verify that the secondary spring support (0F3SR540B140016) is well inserted into its own housing inside the drum (0F3SR450A22002C).
- Insert the secondary spring (0S2085) in its seat into the drum (0F3SR450A22002C) with some grease.
- Verify that the primary spring support (003SUZ118) is well inserted in its own housing inside the pressure plate (0F3SR230C220003).
- Insert the Evoluzione Racing spring (0S1125) into the pressure plate (0F3SR230C220003).
- In order, assemble the complete spring stopper kit starting from the spring stopper plate (0F3CR620E07A008) with the shaped part facing up as shown in the picture. Insert the load bearing (003MG007) and the spring stopper hub (0F3SR450B170007).
- Finally, place the complete spring stopper pack inside the Evoluzione racing spring (0S1125) beforehand mounted onto the pressure plate (0F3SR230C220003). At this point insert the pressure plate (0F3SR230C220003) on the drum (0F3SR450A22002C).
- Insert the notched washer (0F3SR540B170017) in the relevant opening placed on the upper part of the spring stopper hub (0F3SR450B170007), with the convex part facing up, then insert and screw the nut (0F3SR450B170013). Lock with the dynamometric key to the torque suggested by the manufacturer.
- Assemble the complete bearing rest: fit the original bearing in the bearing rest (0F3SR450A22R004). After that insert the seal ring (901SE010) in the groove inside the bearing rest (0F3SR450A22R004). After putting the push rod pin (0F3SR450A220048) in the original bearing, insert the seal ring (901SE012) in its outer groove.
- Position the bearing rest (0F3SR450A22R004) into the relevant opening of the pressure plate (0F3SR230C220003) taking care to correctly align the openings and fix it with the six screws (901VT018) and with the toothed washers (901RD007) with a torque of 2-3Nm.

NB: once the assembly is completed, repeatedly operate the clutch lever to check that pressure plate correctly performs the opening and closing movements.

GENERAL SAFETY REGULATIONS

- IN THIS SHEET ARE REPORTED THE DIRECTIONS TO PERFORM CORRECTLY THE CLUTCH ASSEMBLY OPERATIONS
- STM RESERVES THE RIGHT, WITHOUT NOTICE, TO INTRODUCE ANY TECHNICAL CHANGE WHENEVER DEEMED IT TO BE NECESSARY TO IMPROVE FUNCTION AND QUALITY OF THE PRODUCTS.
- STM ITALY SRL PRODUCTS ARE EXCLUSIVELY INTENDED FOR COMPETITION, NOT SUITABLE ON MOTORBIKES ON PUBLIC ROADS.
- ASSEMBLY OPERATIONS MUST BE PERFORMED BY A SKILLED TECHNICIAN AND MUST BE SCRUPULOUSLY OBSERVED.
- BEFORE MOUNTING THE CLUTCH MAKE A COMPLETE INSPECTION OF THE MOTORBIKE COMPONENTS, IN ORDER TO VERIFY THE POSSIBLE PRESENCE OF FAULTS OR ANOMALIES ON THE VEHICLE.
- MAKE SURE THAT THERE ARE NO MISSING/DAMAGED PARTS IN THE CLUTCH KIT.
- SOME PARTS OF THE CLUTCH AND ITS COMPONENTS CAN HAVE SHARP SURFACE: HANDLE WITH CARE.
- SOME COMPONENTS OF THE CLUTCH, BECAUSE OF THEIR SMALL DIMENSIONS CAN BE SWALLOWED: KEEP AWAY FROM CHILDREN.

RULES FOR PRODUCT CARE AND CLEANING

- ANODIZED and/or LEXAN PARTS: DO NOT USE** on both glossy and matt anodized parts or on lexan components any type of acid or alkaline based degreaser. Use only neutral-based soaps.
- We recommend using a soft, non-abrasive, damp and clean microfiber cloth or synthetic sponge to avoid abrasions and scratches on surfaces.
- However, the use of detergents containing alcohol or aggressive chemical products, but also pickling agents or acids is prohibited.
- Always wash your motorcycle cold, never hot.
- Do not use pressure washers, steam cleaning machines or any type of high pressure washing system or with high operating temperatures, any type of washing of these types can damage or permanently ruin the anodized surfaces or lexan.

